

# Durland Scout Reservation

## Cub Family Camp

June 4, 2022

## Family Guide



### **What Do Youth Want from Scouting?**

When a youth becomes a member of the Boy Scouts of America, one of his first questions is, "When do we go camping?" The Cub Scout program offers a variety of opportunities that include day camps, pack campouts, family camping, and Webelos overnights. Each of these experiences have a different dynamic that gives the youth, their friends and family an appreciation for the outdoors. Camping and outdoor activities fulfill a Scouts's dreams of fun, excitement, and adventure. Camps provide a natural setting for quality time with family and friends. Scout council camps with trained staffers provide an ideal setting for a wide variety of activities.

### **Who Can Attend?**

The whole family is invited to attend Cub Scout Family Camp. Anyone in the household may attend Family Camps hosted at Durland Scout Reservation if there is one registered Cub Scout in the family. Please register soon, space is limited.

### **How much does it Cost?**

Every effort is made to keep costs low while providing a safe, fun event for you and your family. The registration fees help purchase craft supplies, sporting good supplies, insurance, and incidentals to keep a camp open (like electricity, permits, equipment repair, etc.). Cub Scouts will receive an event patch as part of their fees. Most of the overhead costs of keeping Durland Scout Reservation operating is offset by Friends of Scouting and other donations. The base cost per Scout to attend camp is \$25, adults are \$5 and overnight family camping is \$15. Additional patches can be purchased for \$3. Pre-Order lunch available when you register (\$10/meal).

### **How Do I Register for Camp?**

You can register online at: <https://www.ghvbsa.org/familycamp/>

### **Health and Medical Record Forms**

All our overnight family camps are under 72 hours in duration with medical support available within 30 minutes. There will be a Health Officer at Durland during the Saturday Program (9am-5pm). Our Cub Scout Family Camp requires only Part A and Part B of the [BSA Health and Medical Record](#) form. Please have these two parts completed for each member of your party that is attending Family Camp. *These forms will not be collected.*

### **What to Bring to Camp For Overnight Camping**

Please remember to have all items packed in easily carried bags. Bring only what you need and can easily move.

- |   |   |
|---|---|
| <input type="checkbox"/> Signed Health and Medical Record | <input type="checkbox"/> Hat                |
| <input type="checkbox"/> Personal Tents                   | <input type="checkbox"/> Chapstick          |
| <input type="checkbox"/> Day Pack                         | <input type="checkbox"/> Water Bottle       |
| <input type="checkbox"/> Sleeping Bag                     | <input type="checkbox"/> Handbook           |
| <input type="checkbox"/> Jacket                           | <input type="checkbox"/> Raincoat or Poncho |
| <input type="checkbox"/> Flashlight                       | <input type="checkbox"/> Foam Pad           |
| <input type="checkbox"/> Personal First Aid Kit           | <input type="checkbox"/> Washcloth          |
| <input type="checkbox"/> T-Shirts, several                | <input type="checkbox"/> Sweatshirt         |
| <input type="checkbox"/> Pants                            | <input type="checkbox"/> Soap               |
| <input type="checkbox"/> Under-shorts                     | <input type="checkbox"/> Pillow             |
| <input type="checkbox"/> Several pairs socks              | <input type="checkbox"/> Insect Repellent   |
| <input type="checkbox"/> Pajamas                          | <input type="checkbox"/> Spending Money     |
| <input type="checkbox"/> Light Shoes                      | <input type="checkbox"/> Lawn Chair         |

*Do not bring: Pets, Firearms, Fireworks, Alcohol, Illegal Substances,  
Firewood, or Open Toe Shoes (sandals)*

### **What are our Campsite Like?**

You will have a fire ring and a picnic table. You can set up your tents anywhere in your assigned campsite. There are port-a-potties close to the campsite for your use. You will find kindling and firewood in the surrounding area to keep a campfire going (**PLEASE DO NOT BRING FIREWOOD TO CAMP**).



## **Policies**

Certain policies and requirements have been developed by the National Council of the Boy Scouts of America. These policies and requirements will ensure that the camp is a haven for your child and family.

1. No alcoholic beverages are allowed on camp property.
2. Smoke Free Policy – all buildings or facilities are designated as nonsmoking facilities.
3. The Boy Scouts of America will not tolerate any form of child abuse in any form—emotional, physical, sexual, or neglect. Parents should be confident that camp is a haven for their children.
4. Hazing is not permitted in any form.
5. Only the parents of a child may sleep in the same tent with the child.
6. No pets are allowed in camp.
7. Personal firearms and archery items are not allowed on camp property.

## **What to Expect Upon Arrival at Camp**

If you are camping on Friday night, please check in at the Camp Master Cabin when you arrive. Check-in on **Friday is between 5pm-8pm.**

*Program begins at 9am on Saturday morning.* Please stop at the registration table in the Sperling Parking Lot to pick up your packet. **Arrival starts at 745am.** Please leave time to park and walk to your first station.

If you are camping Saturday night your camping site assignment will be in your packet. Friday night campers will receive their packets when they arrive on Friday. Program areas on Saturday will end by 5:30pm. If you are staying Saturday night, check-out time is by 10am.

**You will NOT be able to drive to your campsite while program is running on Sat. June 4. The road leading to the campsites will be closed from 8:30 am to 5:30 pm.**

## **Program at Camp (Please Read)**

Please see attached schedule for camp stations. Each family will be assigned to a Den by the Camp Director prior to arrival. We will do our best to assign youth from the same Pack to the same Den. When you check in at the registration table you will receive a packet with your Den assignment, schedule, patches, and map. Please bring a mask and follow all current Covid guidelines. Do not come to camp if you or a member of your family is sick or has had contact with Covid in the last 14 days. There is no wi-fi available at Durland.

Lunch is available for pre-purchase (\$10 each) when you register. Pre-ordered lunch can be picked up at Sperling during lunch time. *The trading post will be open during the day on Saturday, drinks and small snacks available for purchase.*

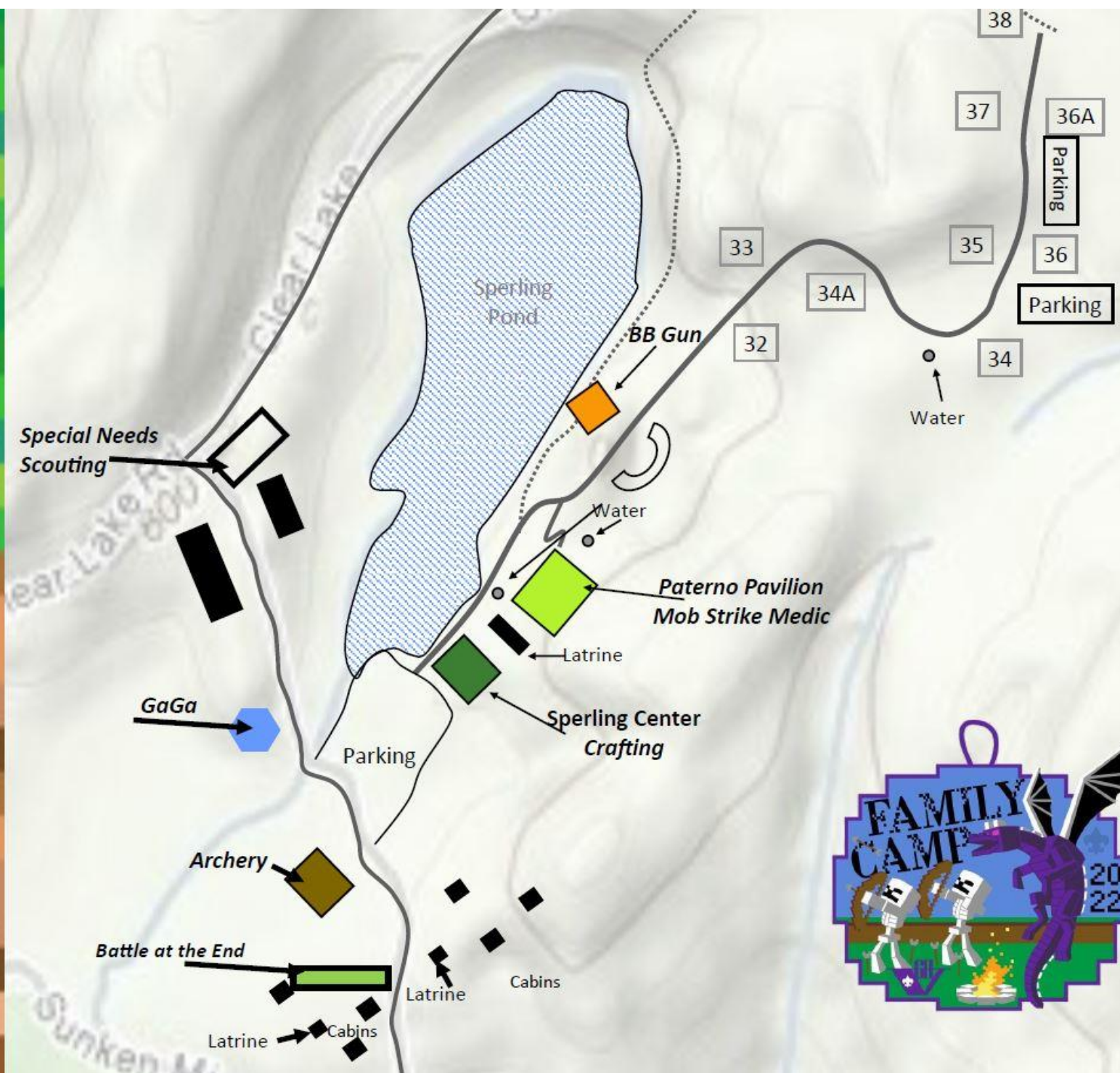



<b>Special Needs</b> <b>Scouting</b> <b>9:15a-10a</b>	<b>Archery</b> <b>9a – 10a</b>	<b>Battle at the End</b> <b>910a – 10a</b>	<b>Crafting</b> <b>9:15a-10a</b>	<b>BB Gun</b> <b>9a-10a</b>	<b>Mob Strike Medic</b> <b>9a – 9:50a</b>
<b>Archery</b> <b>10:15a-11:15a</b>	<b>Special Needs</b> <b>Scouting</b> <b>10:15a – 11a</b>	<b>Mob Strike Medic</b> <b>10:15a - 11am</b>	<b>Battle at the End</b> <b>10:20a – 11:10a</b>	<b>Crafting</b> <b>10:15a-11a</b>	<b>BB Gun</b> <b>10:05a – 11:05a</b>
<b>Battle at the End</b> <b>11:25a-12:10p</b>	<b>BB Gun</b> <b>11:15a – 12:15p</b>	<b>Special Needs</b> <b>Scouting</b> <b>11:15a - 12p</b>	<b>Gaga</b> <b>11:30a – 12p</b>	<b>Archery</b> <b>11:15a – 12:15p</b>	<b>Crafting</b> <b>11:20a – 12:05p</b>
LUNCH 12:15p – 1:15p Pre-Ordered Pick-Up @ Sperling	LUNCH 12:15p – 1:15p Pre-Ordered Pick-Up @ Sperling	LUNCH 12:15p – 1:15p Pre-Ordered Pick-Up @ Sperling	LUNCH 12:15p – 1:15p Pre-Ordered Pick-Up @ Sperling	LUNCH 12:15p – 1:15p Pre-Ordered Pick-Up @ Sperling	LUNCH 12:15p – 1:15p Pre-Ordered Pick-Up @ Sperling
<b>BB Gun</b> <b>1:15p-2:15p</b>	<b>Gaga</b> <b>1:15p-1:45p</b>	<b>Archery</b> <b>1:15p – 2:15p</b>	<b>Special Needs</b> <b>Scouting</b> <b>1:15p-2p</b>	<b>Mob Strike Medic</b> <b>1:15p – 2p</b>	<b>Battle at the End</b> <b>1:15p-2:05p</b>
<b>Mob Strike Medic</b> <b>2:30p-3:15p</b>	<b>Crafting</b> <b>2p – 2:45p</b>	<b>BB Gun</b> <b>2:30p – 3:30p</b>	<b>Archery</b> <b>2:15p-3:15p</b>	<b>Gaga</b> <b>2:15p – 2:45p</b>	<b>Special Needs</b> <b>Scouting</b> <b>2:15p-3p</b>
<b>Crafting</b> <b>3:30p-4:15p</b>	<b>Battle at the End</b> <b>3p – 3:45p</b>	<b>Gaga</b> <b>3:40p-4:10p</b>	<b>BB Gun</b> <b>3:30p-4:30p</b>	<b>Special Needs</b> <b>Scouting</b> <b>3p-3:45p</b>	<b>Gaga</b> <b>3:10p-3:40p</b>
<b>Gaga</b> <b>4:30p-5p</b>	<b>Mob Strike Medic</b> <b>4p-4:45p</b>	<b>Crafting</b> <b>4:25p-5:10p</b>	<b>Mob Strike Medic</b> <b>4:45p-5:15p</b>	<b>Battle at the End</b> <b>4p-4:45p</b>	<b>Archery</b> <b>3:45p-4:45p</b>

Den 1

Den 2

Den 3

Den 4

Den 5

Den 6

OPENING FLAG (Sperling Center) – 8:45am  
CAMPFIRE SAT. NIGHT (Campfire ring) – 8pm: Hosted by Troop 1 Crestwood